



LOW & HIGH RISE BUILDINGS

Project name	Canvas. Max Miami.
Location	1600 NE 1 st Ave. Miami, FL.
Service	Structural design of the shear walls. Upper floors PT slab structural design. Construction engineer management. (Working for CHM Structural Engineers LLC).
Description	37 stories building with 9 th parking floors. Total building area 996,891 sq.ft and 416 feet total height
Architect	COHEN-FREEDMAN-ENCINOSA & ASSOC
Year	2015-2018

Rolando M. Roque MSCE, P.E.
FL License 86571

- Project
- Structure Layout
- Properties
- Structural Objects
- Groups
- Loads
- Named Output Items
- Named Plots

Joint Element: 31705
Story: TR
Ux = 13.315223
Uy = 15.620273
Uz = 0.596386
Rx = -0.003756
Ry = 0.001194
Rz = -0.010534

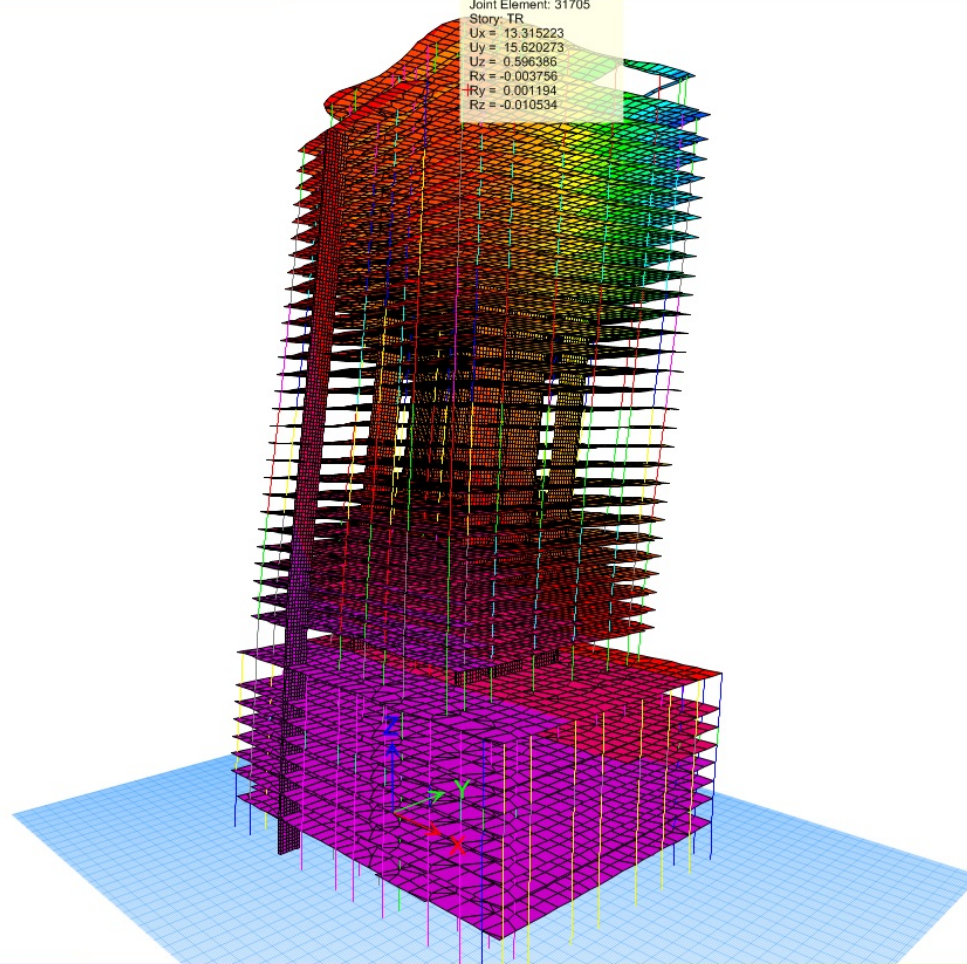

1.6 3.2 4.8 6.4 8.0 9.6 11.2 12.8 14.4 16.0 17.6 19.2 20.8

Deformed Shape

Load Case/Load Combination/Modal Case

☒ Case ☐ Combo ☐ Mode

W02

Scaling

☒ Automatic

☐ User Defined

Scale Factor

Contour Options

☒ Draw Contours on Objects

Contour Component

Show Contours for Displacement UX

Contour Range

Minimum Value for Contour Range 0 in

Maximum Value for Contour Range 0 in

Options

☐ Wire Shadow

☒ Cubic Curve

Hinge State Colored Dots are For

☒ B, C, D and E Points

☐ IO, LS and CP Acceptance Points

OK

Close

Apply